PS600 SLIP SHEET UNIT LOAD STACKER



General Description

The PS600 Slip Sheet Unit Load Stacker is designed to stack unit loads without pallets quickly and accurately, saving up to 60 seconds per stacked unit load versus forklift stacking. The PS600 saves both labor and time while using a minimum amount of floor space.

The PS600 mounts on one side of the unit load conveyor and holds the stretch wrapped unit loads in position with a positive stop gate. The load stacker uses linear rails and bearings to move multiple support bars between the rollers under the unit load. The load is raised and lowered with a variable speed electric drive system. The stacker is controlled by a PLC, which can communicate with the conveyor, stretch wrapper, and unitizer, making it part of the packaging line. By tracking unit loads via a data stream provided from the unitizer, non-matching or partial loads are allowed to pass through.

The PS600 standard setup will handle 40" x 48" unit loads traveling broadside first. The carriage can be adapted to handle a wide range of unit load sizes. Utilizing a heavy-duty, four-post steel frame designed for maximum stability, the PS600 Slip Sheet Unit Load Stacker is ideal for today's high volume warehousing operations.

PS600 SLIP SHEET UNIT LOAD STACKER

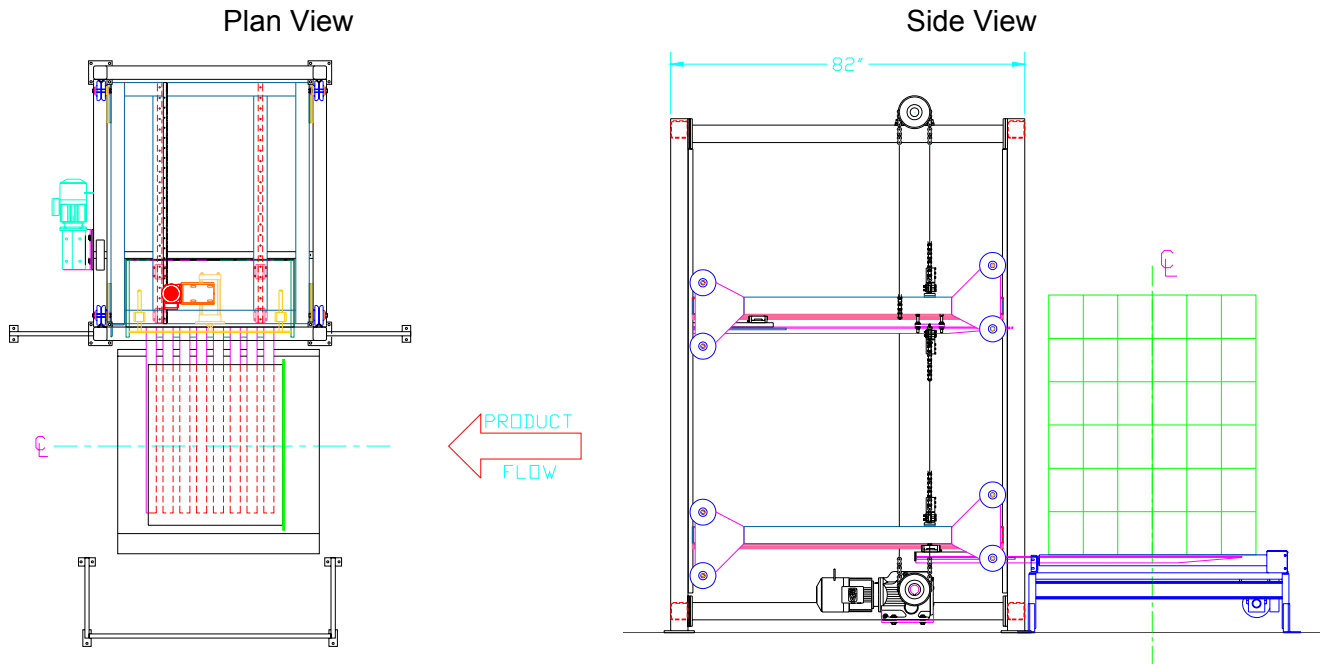

Size (L x W x H)	82" x 95" x 124" (2.1 m x 2.4 m x 3.1 m)
Electrical	480 VAC, 60 Hz, 3 phase, 10 A 110 VAC, 60 Hz, 15 A 24 VDC Control Panel
Pneumatics	3 CFM (85 Lpm) @ 60 PSI (414 kPa) Clean Dry Air
Unit Load Size	40" x 48" unit loads traveling broad side first
Maximum Base Unit Load Height	60" on 30" conveyor 72" on 18" conveyor
Maximum Lifted Unit Load Weight	1000 lbs.
Double Stack Cycle Time	45 sec.

Options

- Human-readable HMI status display (WonderWare, Vorne, RSView, PanelMate, PanelView, more)
- Customer-specified control system (Allen-Bradley PLC/SLC/CLX, Flex I/O, Modicon, more)
- Increased maximum base unit load height
- Adaptation for a wide range of unit load sizes
- "Top Layer Full" detector: avoids stacking on top of a partial unit load
- Multi-stack (3+) capability
- Maintenance gate access safety switches
- Turnkey installation

Kolinahr Systems, Inc.

6840 Ashfield Drive
Cincinnati, OH 45242

E-Mail: sales@kolinahr.cc
Phone: 513-745-9401
Fax: 513-794-3240
On the Web: <http://www.kolinahr.cc>

PS600 SLIP SHEET UNIT LOAD STACKER

Standard Features	Benefits
Compact Size	Easy to install Uses minimal amount of floor space
Variable Speed Electrical Lift Mechanism	Provides low impact start and stops Improves accuracy of lift placement for setting the load down No hydraulics: Low maintenance and environmentally friendly
Multiple Support Bars	Ensures the stable lifting of the load
“Load On Support Bar” Sensors	Ensures that the arms will not retract until the load is down
Linear Rails for Carriage Travel	Lifting carriages ride on heavy-duty linear bearings providing years of dependable quiet operation with minimal vibration
Heavy-Duty Stand & Mounting	Provides very stable load lifting
PLC Fault Messages	Easy display and identification of problems
24 VDC Control Panel	Safer than 120 VAC control panels
Pneumatic Push Bar	Ensures accurate placement of the top load
“Top of Load” Sensor	Minimizes the lifting motion – faster throughput Accurately measures unit load height
High Grade Pneumatics	Minimizes machine maintenance
Industrial Safety Features	LEXAN® safety guarding NEMA 12 controls enclosure Lockable electrical disconnect and air dump valve
Chain Safety Spring	A spring loaded chain take-up on the lifting chain for each tower provides a soft connection to lessen drive impacts during jam conditions
Fault Beacon	Alerts operator that the machine is down

Product Push Plate

